

90° SWEEPING BEND

(R-PVC001 - 25mm)



BISSON
THE PIPE FITTINGS EXPERTS

Designed for changing the direction of a pipe run through 90 degree's on an aspirating smoke detection pipe network. Pipe is designed for aspirating fire detection only.

Installation Instructions:

Use the correct solvent Plusbond 3019. Do not paint. Keep pipe clean and free from dust. Only install with approved pipe. Do not use solvents to clean, only soapy water.

OPERATING TEMPERATURE:
-20°C to 50°C

DIAMETER TOLERANCE:
+/- 0.15mm

OUTSIDE DIAMETER:
32.1mm

WEIGHT: 44.6 Grams

WALL THICKNESS: 4.4mm

INSIDE DIAMETER: 25mm

PIPE COLOUR: Red

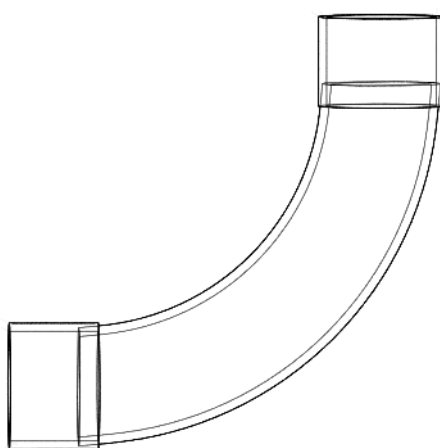

Side Elevation

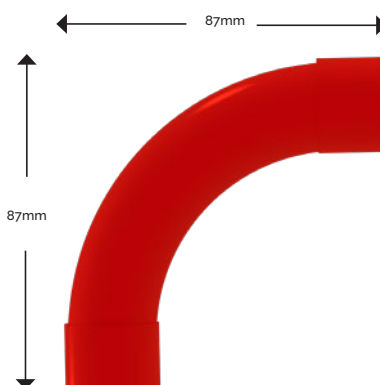

Front Elevation

